

MINI Mobile Digital Video Recorder Wireless Receiver



SPECIFICATION

Image Resolution	Record 320 x 240 MPEG4
LCD Monitor	2.36" TFT LCD MPEG-4 , Encode and Decode (near DVD quality)
Video Playback	Resolution up to 640x360 @30fps/sec. Real Time (AVI file format)
Photo View	JPEG format 640 x 480 (Digital Zoom, NO Image Resolution Loss)
Wired A/V Input	Composite AV input x 2 (4-PIN Connector)
Wireless A/V Input	Composite AV input x 1 (4-PIN Connector) and Wireless 1~4Ch. optional
Audio Video Output Display	Composite AV output x 1 (Phone Jack 3.5mm) 2.36" TFT LCD
System Format	NTSC / PAL System (Optional)
Status Indicator	LED $\bar{\bar{3}}$ Power = Orange , Record = Red, Snap = Yellow $\bar{\bar{3}}$
Power Sources	Internal: Rechargeable Li-Ion Batteries. (4V, 950H/mA) External: AC charger/adaptor
Power Consumption	Typical 400mA (\pm 5%)
Dimension & Weight	123mm (L) x 75mm (W) x 27mm(H)
Operation Temperature	-10 $\bar{\bar{3}}$ ~ 55 $\bar{\bar{3}}$
IR Remote	30 degree / 10 meters (38KHz carrier / 3.3V) AC Charger / Adapter, Li-Ion batteries
Package Includes	(already installed), AV cable, IR Remote Control.

FEATURE:

- Smallest, Lightweight, Portable Digital Audio Video Mini Recorder.
- Digital Audio Video Recording Compression: MPEG-4 near DVD quality.
- Build in 2.36 "LCD monitor
- Video Playback Resolution up to 640 x 360, (Digital Z o o m E n l a r g e d) (30fps/sec. Real Time).
- Picture Resolution: JPEGformat (640 x 480).
- Battery Life Time: 1hrs ~ 1.5hrs. (10%).
- Maximum Recording Time: 4hrs/ 2GB
- Data Storage by SD Card and able to use with any size of capacity.
- Built-in Rechargeable Li-Ion battery.
- OSD Menu Operation
- Enables to display the information of SD capacity.

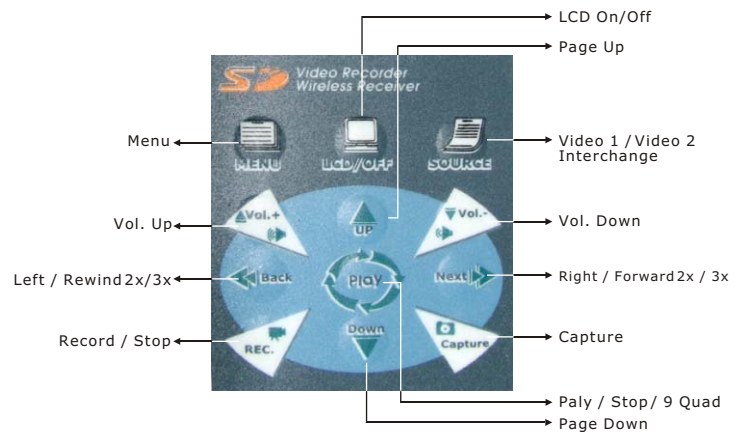
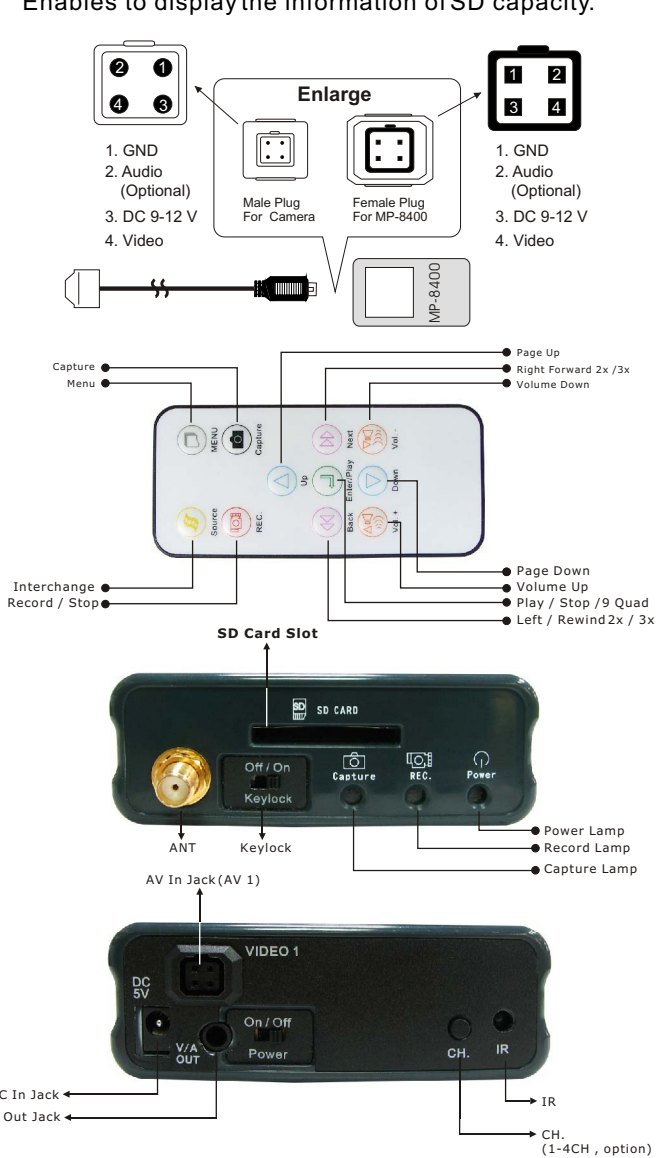

Maximum Recording Time and Capturing:

SD Card Capacity	Recording Time	Photos Capturing
256MB	30 Min. (10%)	5,800pcs (10%)
512MB	60 Min. (10%)	11,600pcs (10%)
1GB	120 Min (10%)	23,200pcs (10%)
2GB	240 Min (10%)	46,400pcs (10%)

Video Sources Connect:

1. Using Racewood's wired cameras (RC206S / RC206B / RC37-SC), please plug to AV1 and AV 2 jack.
 2. Using Racewood's wireless cameras (2.4GHz :C206 / C161 / RC23IR-DNWP) to 2.4PMP-8400-2.36LCD
 3. Using the AV Out of the device connect AV connector and AV cable to TV set or screen to previous file.
- SD Card** Insert SD card into SD compartment.

Switch ON/OFF the Power:

1. Switch the power ON, power status lamp lights in green, and the power is on.
Switch the power OFF, the power lamp will be turn off.

SYSTEM SETUP:

Press **Menu** button for system setting.

DATE TIME SETTING

- 1 Select **SYSTEM** and choose **DATE TIME DISPLAY** for Time and Date setting.



- 2 Press **▲ / ▼ / ◀ / ▶** / to adjust numeric.
- 3 Press **↓ Enter** for setting or press **Menu** anytime to return LIVE Mode.
- 4 Select if you want Date Time appeared on the screen.

DELETE ALL

- 1 Select **SYSTEM** and choose **DELETE** for single file delete or all files delete. Or under LIVE mode press **↓** button to previous files (9 Quad Mode), select file press **Menu** again for quick delete.



Capacity Display

- 1 Select **SYSTEM** then press **↓** on **CAPACITY** to display SD capacity display on screen.



Motion Detect

- 1 Select **FUNCTION** then press **↓** on **MOTION DETECT** to choose if motion detect is needed.

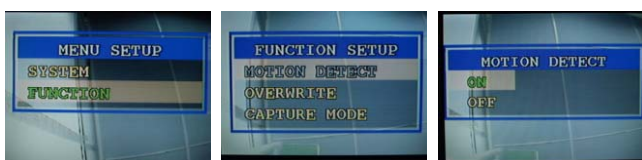

Overwrite

- 1 Select **FUNCTION** then press **↓** on **OVERWRITE** to

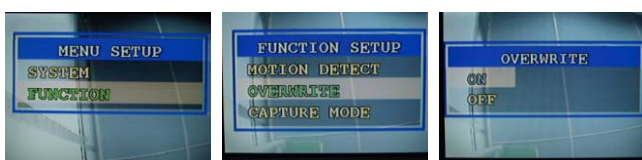

Capture Mode

- 1 Select **FUNCTION** then press **CAPTURE MODE** to choose if overwrite is needed.

- 1) snap a photo
- 2) Record for 5 secondary
- 3) Record for 10 sec



REC MODE

Recording Sources to the Device

- 1 Press the button **SOURCE** (keypad or remote control) and select the video channel available. choose if
- 2 Press the button **REC** for AV recording. Overwrite is needed.
- 3 If input device is not connected, Black image appears.
- 4 If AV cable is connected, live image appears on the screen.
- 5 If SD card is not connected, can not record.
- 6 If SD card take out during the recording, record will be
- 7 Press **REC** button again for stop recording. stop.
- 8 When the SD capacity is over 4/3, the capacity bar RED appear.
- 9 When the SD capacity is full, the device will be stop recording and alarm.

CAPTURE MODE

Under LIVE Mode, press **CAPTURE** button for image capturing.

OPERATIONS INSTRUCTIONS

Rechargeable Battery

The rechargeable Battery has been build-in the devices. Do not open the devices, it may cause damage the internal electronic parts or electric shock.

Using an AC/DC Adapter

An AC/DC adapter allows you to power the device from a common AC wall outlet.

- 1 Connect the AC adapter to the DC IN jack of the device.
- 2 Connect the power cord to that AC adapter and to a wall outlet.
- 3 Start charging power and the adapter red status lamp appears.
- 4 Complete charging power when adapter status lamp turn to green.

NOTE: For the first time usage, charge the battery at less 8 hours. Make sure the power is off while charging the battery.

PLAYMODE

- 1 Under LIVE Mode, press **↓** to enter for review all the records / capture files. Appear 9 equal grid images is displayed. Press **SOURCE** Key to return LIVE Mode.



- 2 File appears  sign, means video file.
- 3 Select a file you want to play.
 - Press **◀ / ▶** to select between previous / next files.

• Press **▲ / ▼** to select between previous / next pages.

- 4 Select the file and press **↓** to enter and start playing back videos or photos enlarge.
- 5 Press **↓** to pause playing back video and press **↓** again to resume playing back video.
- 6 Press **▶▶** to fast forward the videos (press once or twice for 2x / 3x speed), press **trice** to resume playing back
- 7 Press **◀◀** to fast forward the videos (press once or twice for 2x / 3x speed), press **trice** to resume playing back
- 8 Select file without  sign and press **↓** want the photo to enlarge. video.
- 9 Under video playback or photo browsing, press **SOURCE** Key back to 9 equal grid images.