

### Specification

### CMOS Body Camera

CMOS CAMERA				
Item NO.	MO-S308	MO-S508	MO-S608	MO-S708
Video system.	EIA/CCIR	NTSC Only	NTSC/PAL	EIA Only
Number of Effective Pixels	NTSC(EIA)	510x492	510x492	510x492
	PAL(CCIR)	628x582		628x582
CMOS Image Sensor	1/3" B/W	1/4" COLOR	1/3" COLOR	1/4" B/W
Scanning System	2:1 INTERLACE			
Synchronization	INTERNAL			
Resolution (TV Lines)	380 TV Lines			
S/N Ratio	more than 48dB			
Minimum Illumination	0.2Lux / F 1.2	1.5Lux / F 1.2	3Lux / F 1.2	0.05Lux / F 1.2
Electronic Shutter	1/50 - 1/15,000	1/50 - 1/63,000	1/50 - 1/15,000	1/50 - 1/63,000
Horizontal Sync Frequency	NTSC(EIA)-15.734kHz / PAL(CCIR)-15.625kHz			
Vertical Sync Frequency	NTSC(EIA)-60Hz / PAL(CCIR)-50Hz			
Gamma Consumption	0.45			
Video Output	1Vp-p , 75ohms Composite			
Audio Output	Frequency 20-16000Hz, S/N ratio more than 58dB SPL(at 1000Hz)(Ordering in advance)			
Built-In Lens	3.6mm / F2.0(G-type) , 4.3mm / F2.0(P-type)			
Storage Temperature	-30 to 60 Degree C			
Working Temperature	-10 to 45 Degree C			
Power Source	DC 7-12V			
Power Current	50mA(max)	35mA(max)	50mA(max)	35mA(max)



MO-Sx08PA



MO-Sx08GA

### Ordering Information

### Dimension

MODEL	MICRO	PIN HOLE	NOTE
MO-S308G	3.6mm / F2.0		CCIR / EIA
MO-S508G	3.6mm / F2.0		NTSC Only
MO-S608G	3.6mm / F2.0		NTSC / PAL
MO-S708G	3.6mm / F2.0		EIA Only
MO-S308P-3C		3.7mm / F2.0 (CONE)	1/3" B/W CCIR / EIA
MO-S308P-4C		4.3mm / F2.0 (CONE)	1/3" B/W CCIR / EIA
MO-S308P-3F		3.7mm / F2.0 (FLAT)	1/3" B/W CCIR / EIA
MO-S308P-4F		4.3mm / F2.0 (FLAT)	1/3" B/W CCIR / EIA
MO-S308P-3T		3.1mm / F3.4 (SLIM)	1/3" B/W CCIR / EIA
MO-S308P-4T		3.9mm / F3.9 (SLIM)	1/3" B/W CCIR / EIA
MO-S508P-3C		3.7mm / F2.0 (CONE)	1/4" COLOR NTSC Only
MO-S508P-4C		4.3mm / F2.0 (CONE)	1/4" COLOR NTSC Only
MO-S508P-3F		3.7mm / F2.0 (FLAT)	1/4" COLOR NTSC Only
MO-S508P-4F		4.3mm / F2.0 (FLAT)	1/4" COLOR NTSC Only
MO-S508P-3T		3.1mm / F3.4 (SLIM)	1/4" COLOR NTSC Only
MO-S508P-4T		3.9mm / F3.9 (SLIM)	1/4" COLOR NTSC Only
MO-S608P-3C		3.7mm / F2.0 (CONE)	1/3" COLOR NTSC / PAL
MO-S608P-4C		4.3mm / F2.0 (CONE)	1/3" COLOR NTSC / PAL
MO-S608P-3F		3.7mm / F2.0 (FLAT)	1/3" COLOR NTSC / PAL
MO-S608P-4F		4.3mm / F2.0 (FLAT)	1/3" COLOR NTSC / PAL
MO-S608P-3T		3.1mm / F3.4 (SLIM)	1/3" COLOR NTSC / PAL
MO-S608P-4T		3.9mm / F3.9 (SLIM)	1/3" COLOR NTSC / PAL
MO-S708P-3C		3.7mm / F2.0 (CONE)	1/4" B/W EIA Only
MO-S708P-4C		4.3mm / F2.0 (CONE)	1/4" B/W EIA Only
MO-S708P-3F		3.7mm / F2.0 (FLAT)	1/4" B/W EIA Only
MO-S708P-4F		4.3mm / F2.0 (FLAT)	1/4" B/W EIA Only
MO-S708P-3T		3.1mm / F3.4 (SLIM)	1/4" B/W EIA Only
MO-S708P-4T		3.9mm / F3.9 (SLIM)	1/4" B/W EIA Only

**NOTE:**  
M: Medium resolution , H: High resolution  
MO-S708 : DC7~12V MO-SS708 : DC6~10V MO-SSS708: DC5V MO-SV708: DC3V  
MO-S708A : W/Microphone

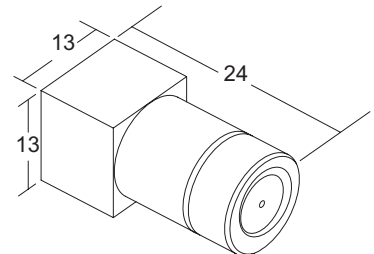
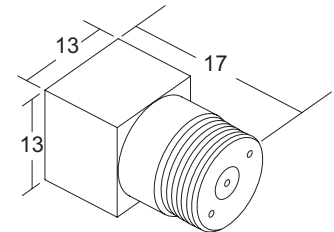

Unit: mm (Approx.)

lens unit diameter height differ for other lenses.  
Please inquire for details.