

Feature

AUTO DETECTION

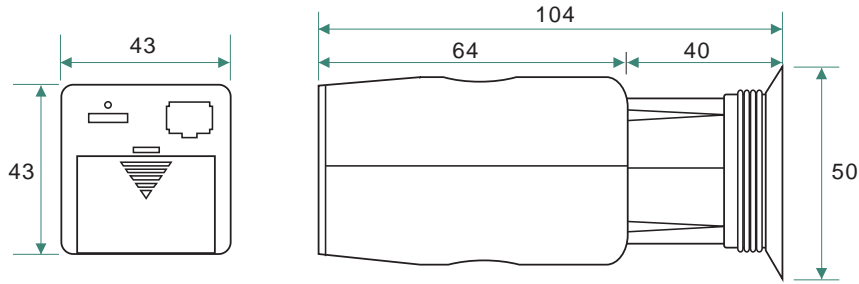

Unit : mm (± 0.5)

Specification

Model	MS-M311
Video system	NTSC/PAL AUTO DETECTION
Dot matrix	432 x 240
Color depth	24 bit
Frame Rate	120 Hz (360 Hz RGB field rate)
Brightness	350 cd/m ²
Contrast Ratio	100:1
White Color Temperature	6,500 ± 500 K
Video Input	1Video Input 1.0Vp-p, 75
Power Consumption	Total Module: 0.5W
Operating temperature	-10 °C to 70 °C
Storage temperature	-30 °C to 83 °C



MS-M311

Instruction Drawing & Description

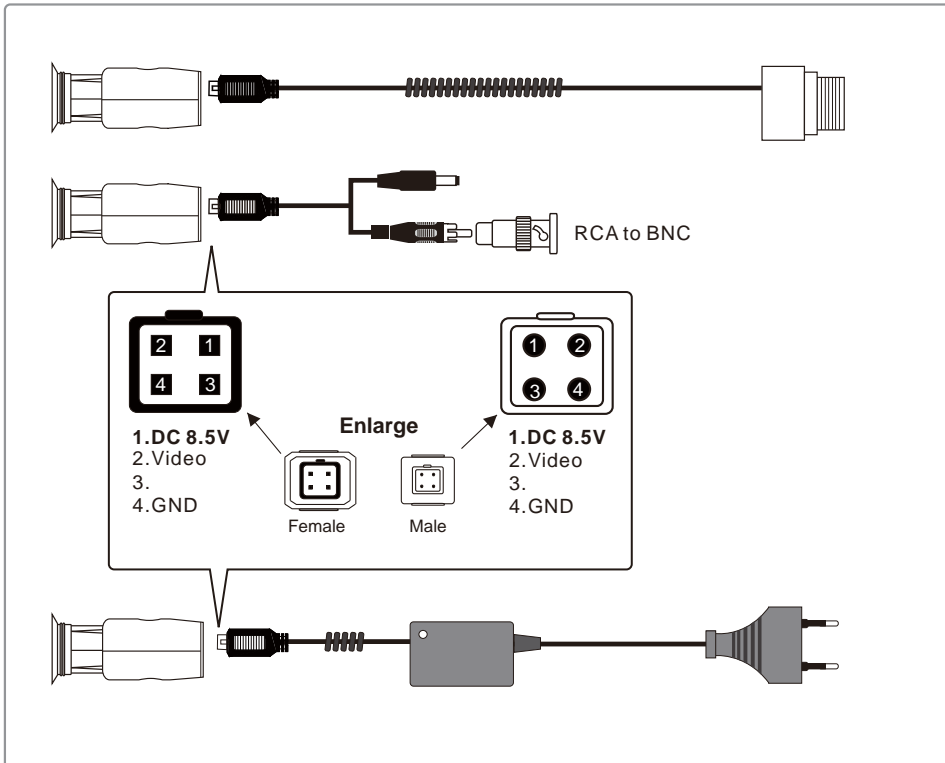

Other information

The Snake Camera With LED Light

► **MO-L805**

1/18" Color CMOS Camera
Pixels : 640x480(NTSC / PAL)
Lens : 0.96mm / F3.0
Dimension : (D)5 x 21 (mm)

