

Body Type

MO-S5588-3D

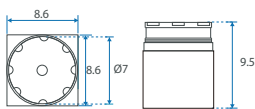

MO-S5588-2V

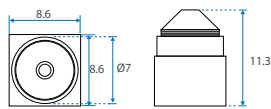

MO-S5588-3T

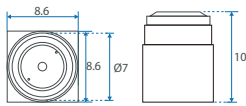

MO-S5588-2S

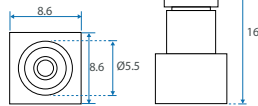

MO-S5588-3K

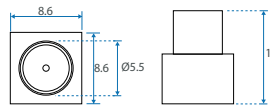

Feature

- Super Wide-angle
- Compact size.
- Hi Resolution up to 480 TV Lines.
- High Performance.
- Outstanding Quality!
- Competitive Price!

Specification

Unit : mm (± 0.5)

Model	MO-S5588
Pixel size	6 um x 6 um
Effective Image Area	3.8mm (H) x 2.9mm (V)X4.86mm(D)
Video system	NTSC / PAL
Number of effective pixels	648 x 488 (NTSC & PAL)
Image sensor	1/4" CCIQ III Color Camera
Resolution(TV Lines)	480 TV Lines
S/N Ratio	47 dB
Dynamic range	63.3 dB
Sensor scan mode	progressive scan
Minimum illumination	0.02LUX / F1.2
Image Transfer Rate	60 field/sec CVBS(NTSC), 50 field/sec (PAL)
Sensitivity	8.2 [V/Lux.sec]
Horizontal sync frequency	NTSC -15.734kHz , PAL - 15.625kHz
Vertical sync frequency	NTSC - 60Hz , PAL - 50Hz
Camera consumption	0.45
Video output	1Vp-p , 75ohm composite
Storage temperature	-30 to 60 Degree C
Working temperature	-10 to 45 Degree C
Power source	DC 5~12V
Power current	100 mA(max)
Dimension (mm)	8.6 x 8.6 (mm)



▲ MO-S5588-3D



▲ MO-S5588-2S



▲ MO-S5588-2V



▲ MO-S5588-3K



▲ MO-S5588-3T,
MO-S5588-4T

Ordering Information

MODEL	FOCUS LENS	MIC.	LENS THREAD
MO-S5588A-3D	3.9mm / F2.8	External	M 7 mm, P0.35mm
MO-S5588A-2V	2.8mm / F3.9	External	M 7 mm, P0.5mm
MO-S5588A-3T	3.4mm / F3.4	External	M 7 mm, P0.5mm
MO-S5588A-4T	3.9mm / F3.9	External	M 7 mm, P0.5mm
MO-S5588A-2S	2.1mm / F2.5	External	M 5.5 mm, P0.35mm
MO-S5588A-3K	2.8mm / F3.9	External	M 5.5 mm, P0.35mm
MO-S5588A-3W	2.8mm / F3.9	External	M7 /top 5 , P0.5mm
MO-S5588-3D	3.9mm / F2.8	X	M 7 mm, P0.35mm
MO-S5588-2V	2.8mm / F3.9	X	M 7 mm, P0.5mm
MO-S5588-3T	3.4mm / F3.4	X	M 7 mm, P0.5mm
MO-S5588-4T	3.9mm / F3.9	X	M 7 mm, P0.5mm
MO-S5588-2S	2.1mm / F2.5	X	M 5.5 mm, P0.35mm
MO-S5588-3K	2.8mm / F3.9	X	M 5.5 mm, P0.35mm
MO-S5588-3W	2.8mm / F3.9	X	M7 /top 5 , P0.5mm

Body Type

MO-S5788-3D

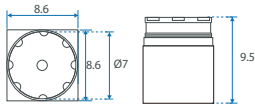

MO-S5788-2V

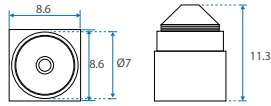

MO-S5788-3T

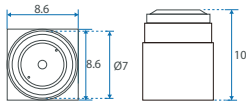

MO-S5788-2S

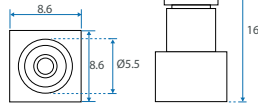

MO-S5788-3K

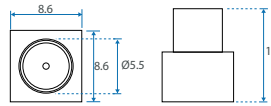

Feature

- Compact size.
- Hi Resolution up to 550 TV Lines.
- High Performance.
- Outstanding Quality!
- Competitive Price!

Specification

Unit : mm (± 0.5)

Model	MO-S5788
Pixel size	6 um x 6 um
Effective Image Area	3.8mm (H) x 2.9mm (V)X4.86mm(D)
Video system	EIA / CCIR
Number of effective pixels	648 x 488 (EIA & CCIR)
Image sensor	1/4" CCIQ III Color Camera
Resolution(TV Lines)	550 TV Lines
S/N Ratio	47 dB
Dynamic range	63.3 dB
Sensor scan mode	progressive scan
Minimum illumination	0.006LUX / F1.2
Image Transfer Rate	60 field/sec CVBS(EIA), 50 field/sec (CCIR)
Sensitivity	8.2 [V/Lux.sec]
Horizontal sync frequency	EIA -15.734kHz, CCIR - 15.625kHz
Vertical sync frequency	EIA - 60Hz, CCIR - 50Hz
Camera consumption	0.45
Video output	1Vp-p, 75ohm composite
Storage temperature	-30 to 60 Degree C
Working temperature	-10 to 45 Degree C
Power source	DC 5~12V
Power current	100 mA(max)
Dimension (mm)	8.6 x 8.6 (mm)



▲ MO-S5788-3D



▲ MO-S5788-2S



▲ MO-S5788-2V



▲ MO-S5788-3K



▲ MO-S5788-3T,
MO-S5788-4T

Ordering Information

MODEL	FOCUS LENS	MIC.	LENS THREAD
MO-S5788A-3D	3.9mm / F2.8	External	M 7 mm, P0.35mm
MO-S5788A-2V	2.8mm / F3.9	External	M 7 mm, P0.5mm
MO-S5788A-3T	3.4mm / F3.4	External	M 7 mm, P0.5mm
MO-S5788A-4T	3.9mm / F3.9	External	M 7 mm, P0.5mm
MO-S5788A-2S	2.1mm / F2.5	External	M 5.5 mm, P0.35mm
MO-S5788A-3K	2.8mm / F3.9	External	M 5.5 mm, P0.35mm
MO-S5788A-3W	2.8mm / F3.9	External	M7 /top 5, P0.5mm
MO-S5788-3D	3.9mm / F2.8	X	M 7 mm, P0.35mm
MO-S5788-2V	2.8mm / F3.9	X	M 7 mm, P0.5mm
MO-S5788-3T	3.4mm / F3.4	X	M 7 mm, P0.5mm
MO-S5788-4T	3.9mm / F3.9	X	M 7 mm, P0.5mm
MO-S5788-2S	2.1mm / F2.5	X	M 5.5 mm, P0.35mm
MO-S5788-3K	2.8mm / F3.9	X	M 5.5 mm, P0.35mm
MO-S5788-3W	2.8mm / F3.9	X	M7 /top 5, P0.5mm