

Board Type

MO-B8522

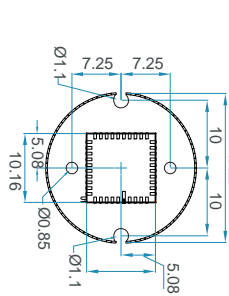

MO-B8519

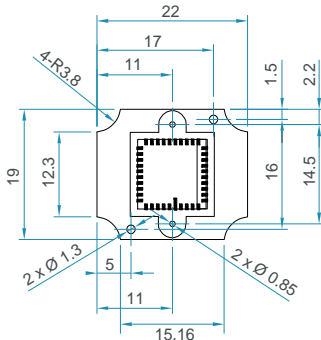

MO-B8526

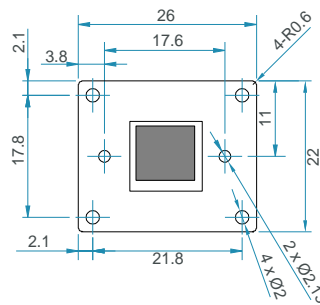

Feature

- With UTC function
- Hi Resolution up to 710 TV Lines.
- High Performance.
- Outstanding Quality!
- Competitive Price!

Specification

Unit : mm (± 0.5)

Model	MO-B8522	MO-B8519	MO-B8526
Video system	NTSC / PAL		
Number of effective pixels	976 (H) x 496(V) (NTSC & PAL)		
Effective Image Area	4.88 mm x 3.67 mm (Diagonal : 5.97mm)		
Pixel Size	5.00 um x 7.40 um		
Image sensor	1/3" Color CCIQ III 960H Camera		
Resolution(TV Lines)	710 TV Line over (NTSC) , 740 TV Line over (PAL)		
S/N Ratio	46.4 dB		
Dynamic range	63.5 [dB]		
Sensor scan mode	Interlaced 60 fields		
Minimum illumination	0.05Lux at F1.2 20IRE		
Shutter Speed	1/60~1/200,000 (NTSC) , 1/50~1/170,000 (PAL)		
Sensitivity	11.4 [V/Lux.sec]		
Horizontal sync frequency	NTSC -15.734kHz , PAL - 15.625kHz		
Vertical sync frequency	NTSC - 60Hz , PAL - 50Hz		
Camera consumption	0.45		
Video output	1Vp-p , 75ohm composite		
Storage temperature	-30 to 60 Degree C		
Working temperature	-10 to 45 Degree C		
Power source	Camera input: DC 5~12V		
Power current	50~70mA@DC12.0V 110~130mA@DC5.0V		
Dimension (mm)	Ø22 mm	19 x 22 mm	22 x 26 mm

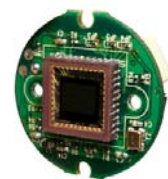

▲ MO-B8522

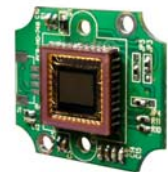

▲ MO-B8519

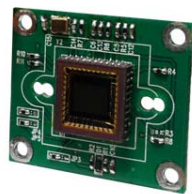

▲ MO-B8526

Ordering Information

Model	Built-in Lens	Microphone	Model	Built-in Lens	Microphone
MO-B85XX-3C	3.7mm/F2.0	N/A	MO-B85XXA-3C	3.7mm/F2.0	with Microphone
MO-B85XX-4C	4.3mm/F2.0		MO-B85XXA-4C	4.3mm/F2.0	
MO-B85XX-3F	3.7mm/F2.0		MO-B85XXA-3F	3.7mm/F2.0	
MO-B85XX-4F	4.3mm/F2.0		MO-B85XXA-4F	4.3mm/F2.0	
MO-B85XX-3T	3.1mm/F3.4		MO-B85XXA-3T	3.1mm/F3.4	
MO-B85XX-4T	3.9mm/F3.9		MO-B85XXA-4T	3.9mm/F3.9	
MO-B85XX-3G	3.6mm/F2.0		MO-B85XXA-3G	3.6mm/F2.0	

MO-B85XXA

A: W/MIC.

Body Type

Camera with UTC remote function
(UTC-100 Sold separately)

The main function (exposure, WB, Day & Night, image & setup, function setup, reset) to the five buttons (enter, up, down, left, right) toggles

Using menu

Using buttons (enter, up, down, left, right) to choose items and set it.

● **Exposure**

- LENS TYPE —
- SHUTTER —
- FLICKER —
- AGC —
- BRIGHTNESS — ◀◀ — +▶▶
- RETURN



▲ UTC-100 (Sold separately)

● **White Balance (WB)**

- MODE —
- R GAIN — ◀◀ — +▶▶
- B GAIN — ◀◀ — +▶▶

● **Day & Night**

- MODE —
- BURST —
- D → N LEVEL —
- D ← N LEVEL —

- D=>N LEVEL determines the time at which the change occurs (lower the faster)
- N=>D LEVEL determines the time at which the change occurs (higher the faster)

● **IMAGE & SETUP**

- BRIGHTNESS — ◀◀ — +▶▶
- CONTRAST — ◀◀ — +▶▶
- COLOR GAIN — ◀◀ — +▶▶
- SHARPNESS — ◀◀ — +▶▶
- NR —
- MIRROR —
- LANGUAGE —
- RETURN

● **FUNCTION SETUP**

- MOTION —
- ALARM —
- PRIVACY —
- SYSTEM SETUP
- RETURN

● **RESET**

(reset current setting back to default setting)

● **SAVE & EXIT**

(exit after saving current setting)

(UTC Controller sold separately)

