

Body Type

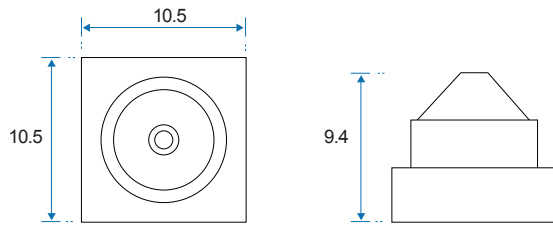

Feature

- Compact Size.
- Sketch Implant
- High Performance.
- NTSC/PAL Compatible
- H. reflect/NO H. reflect

Specification

Unit : mm (± 0.5)

Model	MO-D5510-2V
Video system	NTSC / PAL
Number of effective pixels	648 x 488(NTSC & PAL)
Image sensor	1/4" CCIQ III Color Camera
Resolution(TV Lines)	480 TV Lines
S/N Ratio	47 [dB]
scan mode	progressive
Dynamic range	63.3 [dB]
Sensitivity	8.2 [V/Lux.sec]
Minimum illumination	0.02 Lux/ F1.2
Farme rate	60 field/sec (NTSC) , 50 field/sec (PAL)
Horizontal sync frequency	NTSC(EIA) -15.734kHz , PAL(CCIR) - 15.625kHz
Vertical sync frequency	NTSC(EIA) - 60Hz , PAL(CCIR) - 50Hz
Camera consumption	0.45
Video output	1Vp-p , 75ohm composite
Storage temperature	-30 to 60 Degree C
Working temperature	-10 to 45 Degree C
Power source	Camera :DC 5~12V
Power current	100mA-max(DC 5V)
Dimension (mm)	10.5 x 10.5 (mm)

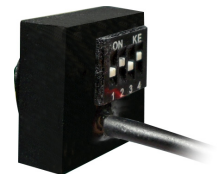
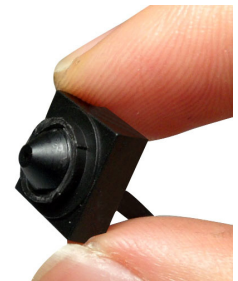

MO-D5510-2V

Ordering Information

NTSC/ NO H. reverse		ON		ON	
PAL/ NO H. reverse		ON	ON		
NTSC/ H. reverse	ON			ON	
PAL/ H. reverse	ON		ON		

MODEL	Built-in Lens
MO-D5510-2V	2.8mm/F3.9
NOTE	

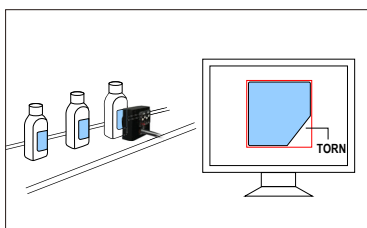
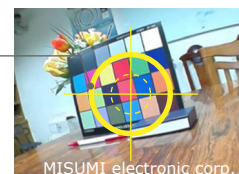

image overlay !
(ordering in advance)



text overlay !
(ordering in advance)

Image overlay graphics & line & text.
(MISUMI create a camera by customer requirements and custom design to meet specific needs.)