

Feature

- 5.0 MegaPixel USB QSXGA!
- High Sensitivity!
- 4 Pcs white LED.
- Full HD image pixel
- 360° Dual Camera

UNIT:±0.5mm

Specification

Model	MD-TCAM-42
Max. FRAME RATE	<ul style="list-style-type: none"> ● Full 5.0M 2592 x 1944 /15 fps , ● FHD 1920 x 1080 /30 fps , ● SXGA 1280 X 960 /30 fps , ● HD 1280 x 720 /60 fps , ● VGA 640 x 480 /60 fps
pixel size	1.4um x 1.4um
Image sensor	1/4" CCIQ III DIGITAL QSXGA CMOS Camera module
Image area	3.651 x 2.744mm
Scan mode	progressive
Sensitivity	Sensitivity 5100 e-/lux.sec
Dynamic Range	63 dB
UVC FORMAT	MJPEG
Storage temperature	-30 to 60 Degree C
Working temperature	-10 to 45 Degree C
Built-in Lens	f 3.0 /F# 2.0
View angle	H= 62° 19'; V= 48° 48'; D= 74° 14'
INTERFACE	USB 2.0 (Compliant with USB Video Class 1.1 standard)
OUTPUT FORMAT	RAW 10Bit
LED	white LED x 4
Operating system	Windows 7, Windows 8 (WINDOWS 7 operating system in use, you need to install MJPG decoders.)
Power source	DC 5V (USB)
Power current	camera: 495mA (working), 380mA (standby) LED: 50mA
Dimension(mm)	30 x 25 x 25mm
White balance	AUTO
Gain control	AUTO
Exposure	AUTO

74° view angle



74° view angle

MD-TCAM-42

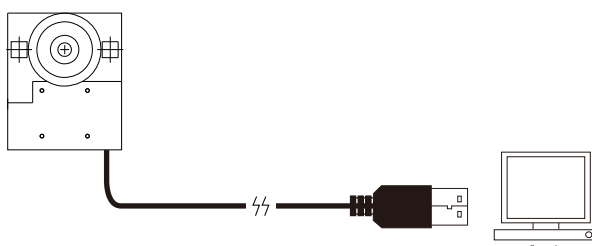

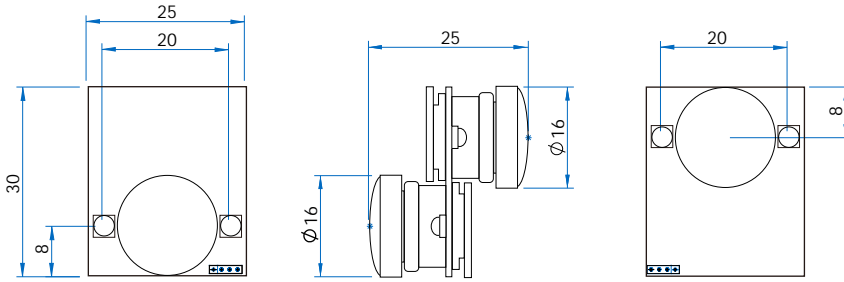

Feature

- 5.0 MegaPixel USB QSXGA!
- High Sensitivity!
- 4 Pcs white LED.
- Full HD image pixel
- 360° Dual Camera

UNIT:±0.5mm

Specification

Model	MD-TCAM-42
Max. FRAME RATE	<ul style="list-style-type: none"> ● Full 5.0M 2592 x 1944 /15 fps , ● FHD 1920 x 1080 /30 fps , ● SXGA 1280 X 960 /30 fps , ● HD 1280 x 720 /60 fps , ● VGA 640 x 480 /60 fps
pixel size	1.4um x 1.4um
Image sensor	1/4" CCIQ III DIGITAL QSXGA CMOS Camera module
Image area	3.651 x 2.744mm
Scan mode	progressive
Sensitivity	Sensitivity 5100 e-/lux.sec
Dynamic Range	63 dB
UVC FORMAT	MJPEG
Storage temperature	-30 to 60 Degree C
Working temperature	-10 to 45 Degree C
Built-in Lens	f 3.0 /F# 2.0
View angle	H= 62° 19'; V= 48° 48'; D= 74° 14'
INTERFACE	USB 2.0 (Compliant with USB Video Class 1.1 standard)
OUTPUT FORMAT	RAW 10Bit
LED	white LED x 4
Operating system	Windows 7, Windows 8 (WINDOWS 7 operating system in use, you need to install MJPG decoders.)
Power source	DC 5V (USB)
Power current	camera: 495mA (working), 380mA (standby) LED: 50mA
Dimension(mm)	30 x 25 x 25mm
White balance	AUTO
Gain control	AUTO
Exposure	AUTO

74° view angle



74° view angle

MD-TCAM-42

