

| No lens | 62° | 74° | 81° | 94° | 99° | 169° |
|----------------------------------|----------------------------------|----------------------------------|----------------------------------|----------------------------------|----------------------------------|----------------------------------|
| <p>TD-B36305 series</p> | <p>(with high-intensity LED)</p> | <p>(with high-intensity LED)</p> | <p>(with high-intensity LED)</p> | <p>(with high-intensity LED)</p> | <p>(with high-intensity LED)</p> | <p>(with high-intensity LED)</p> |
| <p>TD-BL36305 series</p> | <p>(with high-intensity LED)</p> | <p>(with high-intensity LED)</p> | <p>(with high-intensity LED)</p> | <p>(with high-intensity LED)</p> | <p>(with high-intensity LED)</p> | <p>(with high-intensity LED)</p> |
| <p>TD-BL36305S series</p> | <p>(with high-intensity LED)</p> | <p>(with high-intensity LED)</p> | <p>(with high-intensity LED)</p> | <p>(with high-intensity LED)</p> | <p>(with high-intensity LED)</p> | <p>(with high-intensity LED)</p> |
| <p>TD-B36310 series</p> | <p>(with high-intensity LED)</p> | <p>(with high-intensity LED)</p> | <p>(with high-intensity LED)</p> | <p>(with high-intensity LED)</p> | <p>(with high-intensity LED)</p> | <p>(with high-intensity LED)</p> |

TD-B36305LH-74

| | | | | |
|---------------------------------------|---|--|------|----------------------------------|
| SERIES | T | Ultra mini size | | |
| | FT | Ultra mini size with snapshot and freeze frame | | |
| CONNECTOR | D | USB 2.0 A type | | |
| | M | Micro USB 2.0 OTG B type | | |
| | T | USB type C | | |
| CAMERA BODY | B | Board type (module) | | |
| | VB | Board type (module)+dimmer | | |
| | BL | Board type (side view) | | |
| | VBL | Board type (side view)+dimmer | | |
| | T | Tube type | | |
| | V | Tube type+dimmer | | |
| CAMERA TYPE | 36305 | color (round / rectangle-side view) | | |
| | 36305S | color (rectangle-ultra slim board, side view) | | |
| | 36310 | color (square) | | |
| | 363M5 | B/W (round / rectangle-side view) | | |
| | 363M5S | B/W (rectangle-ultra slim board, side view) | | |
| | 363M10 | B/W (square type) | | |
| | 363P5 | color (round / rectangle-side view) | | |
| | 363P5S | color (rectangle-ultra slim board, side view) | | |
| | 363P10 | color (square) | | |
| | 363C5 | B/W (round / rectangle-side view) | | |
| 363C5S | B/W (rectangle-ultra slim board, side view) | | | |
| 363C10 | B/W (square type) | | | |
| * 363"P5, 363"C5 : crop sensor series | | | | |
| LED | LH | high intensity white LED | | |
| | L8 | IR 850nm LED x 6 | | |
| | L9 | IR 940nm LED x 6 | | |
| LENS | 56 | 3.4mm/F2.8/6.0 (56°) | *81 | 1.83mm/F2.0/F5.0/8.0 (81°) |
| | 62 | 3.0mm/F2.4 (62°) | *94 | 1.55mm/F5.7 (94°) |
| | 71 | 2.46mm/F2.0 (71°) | *99 | 1.5mm/F5.7 (99°) |
| | 74 | 2.34mm/F2.2 (74°) | *169 | 1.523mm/F4.8/6.0/8.0 (169° lens) |

| Model | xxx-36305 series | | | | | xxx-363P5 series | | | | |
|---------------------|---|-------|-------|---------------|-----------------|--|-------|-------|---------------|-----------------|
| | binning type | | | | | crop sensor type / for telescope application | | | | |
| Feature | Resolution | fps | | Diagonal (mm) | Image area (mm) | Resolution | fps | | Diagonal (mm) | Image area (mm) |
| | | YUV | MJPEG | | | | YUV | MJPEG | | |
| | 2592 x 1944 | NC | 30fps | 1/5" CMOS | 2.90 x 2.18 | 2592 x 1944 | NC | 30fps | 1/5" CMOS | 2.90 x 2.18 |
| | 2048 x 1536 | NC | 30fps | | | 2048 x 1536 | NC | 30fps | 1/6.3" CMOS | 2.29 x 1.72 |
| | 1920 x 1080 | NC | 30fps | | | 1920 x 1080 | NC | 30fps | 1/7.3" CMOS | 2.15 x 1.21 |
| | 1600 x 1200 | NC | 30fps | | | 1600 x 1200 | NC | 30fps | 1/8" CMOS | 1.79 x 1.34 |
| | 1280 x 720 | NC | 30fps | | | 1280 x 720 | NC | 30fps | 1/11" CMOS | 1.43 x 0.81 |
| | 1024 x 768 | NC | 30fps | | | 1024 x 768 | NC | 30fps | 1/12.5" CMOS | 1.15 x 0.86 |
| | 640 x 480 | 30fps | 30fps | | | 640 x 480 | 30fps | 30fps | 1/20" CMOS | 0.72 x 0.54 |
| | 320 x 240 | 30fps | 30fps | | | 320 x 240 | 30fps | 30fps | 1/40" CMOS | 0.36 x 0.27 |
| Sensitivity | 3.6V/lux-sec | | | | | | | | | |
| Pixel size(μm) | 1.12 x 1.12 | | | | | | | | | |
| Suhtter | rolling shutter | | | | | | | | | |
| SNR | 37 dB | | | | | | | | | |
| Dynamic range | 64.7 dB | | | | | | | | | |
| Storage temperature | -30 to 60 Degree C | | | | | | | | | |
| Working temperature | -10 to 45 Degree C | | | | | | | | | |
| Lens / angle | specify when ordering | | | | | | | | | |
| LED | specify when ordering (white / IR 940nm / IR 850nm) | | | | | | | | | |
| Power source | DC 5V (USB) | | | | | | | | | |
| Power current | 220mA (no LED) | | | | | | | | | |
| Operating system | windows 10, Linux, MAC OSX | | | | | | | | | |
| Interface | USB 2.0 | | | | | | | | | |



*Available for mainboard to the connector (Spec for reference only. Actual product may vary.)

| Type | Cable length | Cable OD |
|------|--------------------|--------------|
| 1 | 10~200 (cm) (TBD) | 0.9 +0.1(mm) |
| 2 | 10~200 (cm) (TBD) | 1.7 +0.1(mm) |
| 3 | 10~200 (cm) | 2.5 +0.1(mm) |
| 4 | 10~400 (cm) (TBD) | 2.8 +0.1(mm) |
| 5 | 10~1000 (cm) (TBD) | 3.5 +0.1(mm) |
| 6 | 10~1500 (cm) | 5.0 +0.1(mm) |

* For 81, 94, 99, 169° lens, image has 5% dark corner.
* For 81, 94, 99, 169° lens, image circle is Ø3.27

| No lens | 62° | 74° | 81° | 94° | 99° | 169° |
|-----------------------------------|----------------------------------|----------------------------------|----------------------------------|----------------------------------|----------------------------------|----------------------------------|
| <p>xxx-B36305 series</p> | <p>(with high-intensity LED)</p> | <p>(with high-intensity LED)</p> | <p>(with high-intensity LED)</p> | <p>(with high-intensity LED)</p> | <p>(with high-intensity LED)</p> | <p>(with high-intensity LED)</p> |
| <p>xxx-BL36305 series</p> | <p>(with high-intensity LED)</p> | <p>(with high-intensity LED)</p> | <p>(with high-intensity LED)</p> | <p>(with high-intensity LED)</p> | <p>(with high-intensity LED)</p> | <p>(with high-intensity LED)</p> |
| <p>xxx-BL36305S series</p> | <p>(with high-intensity LED)</p> | <p>(with high-intensity LED)</p> | <p>(with high-intensity LED)</p> | <p>(with high-intensity LED)</p> | <p>(with high-intensity LED)</p> | <p>(with high-intensity LED)</p> |

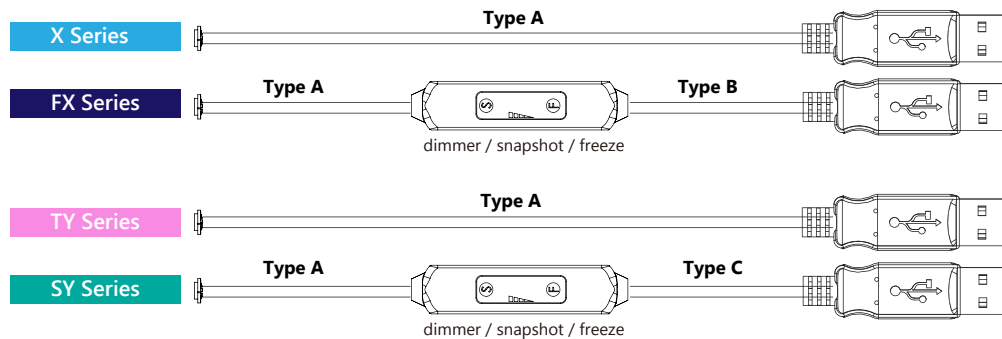

*Available for mainboard to the connector (Spec for reference only. Actual product may vary.)

| Type A | Cable length | Cable OD | Type B | Cable length | Cable OD | Type C | Cable length | Cable OD |
|--------|--------------|--------------|--------|---------------|--------------|--------|--------------|-------------|
| 1 | 10~80 (cm) | 1.9 ±0.1(mm) | 1 | *10~200 (cm) | 0.9 +0.1(mm) | 1 | 10~250 (cm) | 3.6±0.1(mm) |
| 2 | 10~130 (cm) | 2.8 ±0.1(mm) | 2 | *10~200 (cm) | 1.7 +0.1(mm) | | | |
| 3 | 10~350 (cm) | 3.8 ±0.1(mm) | 3 | 10~200 (cm) | 2.5 +0.1(mm) | | | |
| | | | 4 | *10~400 (cm) | 2.8 +0.1(mm) | | | |
| | | | 5 | *10~1000 (cm) | 3.5 +0.1(mm) | | | |
| | | | 6 | 10~1500 (cm) | 5.0 +0.1(mm) | | | |

XD-B36305LH-74

| | | | |
|--------------------|--|---|---------------------------------------|
| SERIES | X | low temperature and tiny size. USB 2.0 interface | |
| | FX | low temperature and tiny size. With snapshot and freeze frame function. USB 2.0 interface | |
| | TY | low temperature and tiny size. USB 3.0 interface | |
| | SY | low temperature and tiny size. With snapshot and freeze frame function. USB 3.0 interface | |
| CONNECTOR | D | USB 2.0 or USB 3.0 A type | |
| | M | Micro USB 2.0 OTG B type | |
| | T | USB 2.0 or USB 3.0 type C | |
| TYPE | B | Board type (module) | |
| | VB | Board type (module)+dimmer | |
| | BL | Board type (side view) | |
| | VBL | Board type (side view)+dimmer | |
| | T | Tube type | |
| | V | Tube type+dimmer | |
| CAMERA TYPE | 36305 | color (round / rectangle-side view) | |
| | 36305S | color (rectangle-ultra slim board, side view) | |
| | 363M5 | B/W (round / rectangle-side view) | |
| | 363M5S | B/W (rectangle-ultra slim board, side view) | |
| | 363P5 | color (round / rectangle-side view) | |
| | 363P5S | color (rectangle-ultra slim board, side view) | |
| | 363C5 | B/W (round / rectangle-side view) | |
| 363C5S | B/W (rectangle-ultra slim board, side view) * 363"P"5, 363"C"5 : crop sensor series | | |
| LED | LH | high intensity white LED | |
| | L8 | IR 850nm LED x 6 | |
| | L9 | IR 940nm LED x 6 | |
| LENS | 56 | 3.4mm/F2.8/6.0 (56°) | *81 1.83mm/F2.0/F5.0/8.0 (81°) |
| | 62 | 3.0mm/F2.4 (62°) | *94 1.55mm/F5.7 (94°) |
| | 71 | 2.46mm/F2.0 (71°) | *99 1.5mm/F5.7 (99°) |
| | 74 | 2.34mm/F2.2 (74°) | *169 1.523mm/F4.8/6.0/8.0 (169° lens) |

* For 81, 94, 99, 169° lens, image has 5% dark corner.
* For 81, 94, 99, 169° lens, image circle is Ø3.27

| Model | xxx-36305 series | | | xxx-363P5 series | | |
|---------------------|--|-----------------|-----------------|--|--------------------|-----------------|
| Feature | binning type | | | crop sensor type / for telescope application | | |
| | Resolution | Diagonal (mm) | Image area (mm) | Resolution | Diagonal (mm) | Image area (mm) |
| | 2592 x 1944 ; 2048 x 1536 ; 1920 x 1080 ; 1600 x 1200 ; 1280 x 720 ; 1024 x 768 ; 640 x 480 ; 320 x 240 | 1/5" CMOS color | 2.90 x 2.18 | 2592 x 1944 | 1/5" CMOS color | 2.90 x 2.18 |
| | | | | 2048 x 1536 | 1/6.3" CMOS color | 2.29 x 1.72 |
| | | | | 1920 x 1080 | 1/7.3" CMOS color | 2.15 x 1.21 |
| | | | | 1600 x 1200 | 1/8" CMOS color | 1.79 x 1.34 |
| | | | | 1280 x 720 | 1/11" CMOS color | 1.43 x 0.81 |
| | | | | 1024 x 768 | 1/12.5" CMOS color | 1.15 x 0.86 |
| | | | | 640 x 480 | 1/20" CMOS color | 0.72 x 0.54 |
| 320 x 240 | 1/40" CMOS color | 0.36 x 0.27 | | | | |
| Sensitivity | 3.6V/lux-sec | | | | | |
| Pixel size(μm) | 1.12 x 1.12 | | | | | |
| Suhtter | rolling shutter | | | | | |
| SNR | 37 dB | | | | | |
| Dynamic range | 64.7 dB | | | | | |
| Storage temperature | -30 to 60 Degree C | | | | | |
| Working temperature | -10 to 45 Degree C | | | | | |
| Lens / angle | specify when ordering | | | | | |
| LED | specify when ordering (white / IR 940nm / IR 850nm) | | | | | |
| Power source | DC 5V (USB) | | | | | |
| Power current | 220mA (no LED) | | | | | |
| Operating system | windows 10, Linux, MAC OSX | | | | | |

Video demo (To view video in 5MP resolution, must download the file.)

| Resolution | Still image /video | Demo link | Note |
|-------------------|--------------------|---|-----------------------------|
| 2592 x 1944 (5MP) | Still image | https://reurl.cc/L0QNGy | still update |
| 2592 x 1944 (5MP) | Video | https://reurl.cc/bzN7OM | with 74° lens (2.34mm/F2.2) |
| 2592 x 1944 (5MP) | Video | https://reurl.cc/WE8Dnx | with 74° lens (2.34mm/F2.2) |
| 2592 x 1944 (5MP) | Video | https://reurl.cc/zbKAV7 | with 74° lens (2.34mm/F2.2) |

Specifically Designed

Using micro connector, camera can pass through narrow pipeline easily.
Nano 4pin / Nano 13pin -specify when ordering

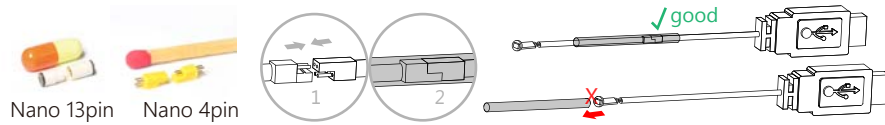

XD-B36305-74



XD-B36305LH-77



XD-B36305-74



XD-B36305-62

*S / F function: snapshot and freeze function

| Model | Interface | Frame rate | S / F function* |
|--------------|-----------|-------------------|-----------------|
| XD-B36305 | USB 2.0 | 30fps MJPEG | N/A |
| FXD-B36305 | | 30fps MJPEG | ● |
| TYD-B36305 | USB 3.0 | 30fps MJPEG / YUV | N/A |
| SYD-B36305 | | 30fps MJPEG / YUV | ● |
| XD-BL36305 | USB 2.0 | 30fps MJPEG | N/A |
| FXD-BL36305 | | 30fps MJPEG | ● |
| TYD-BL36305 | USB 3.0 | 30fps MJPEG / YUV | N/A |
| SYD-BL36305 | | 30fps MJPEG / YUV | ● |
| XD-BL36305S | USB 2.0 | 30fps MJPEG | N/A |
| FXD-BL36305S | | 30fps MJPEG | ● |
| TYD-BL36305S | USB 3.0 | 30fps MJPEG / YUV | N/A |
| SYD-BL36305S | | 30fps MJPEG / YUV | ● |

- 5 Megapixel resolution
- High resolution and high performance!
- Miniature and compact size!
- Variety of shape for selection!

Other information

10-VD608-363-4W series

- 4 way articulation borescope
- Ø6.0 x 10 mm ultra short camera head
- 5 Mega-pixel high resolution
- With high-intensity LED (MISUMI patent)
- Camera bend angle up to 135 degrees

