

Model: TYD-DB37209R-76
Board type, 76° lens

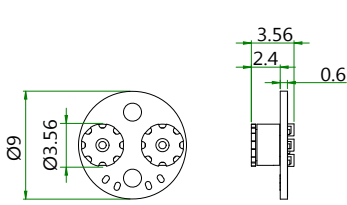

Model: TYD-DB37209R-128
Board type, 128° lens

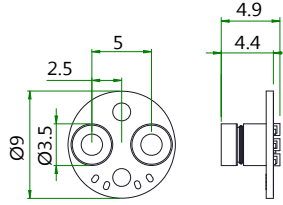

Model: TYD-DB37209R-140
Board type, 140° lens

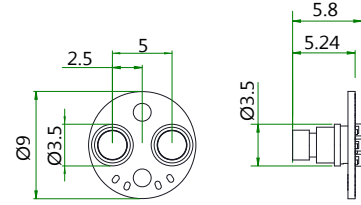

Specification

Model	TYD-DB37209R	TYD-DB37209RL
LED	N/A	LED x 6 (white/IR 940nm/IR 850nm -specify when ordering)
Power current	120mA	140mA
Power source	DC 5V (USB)	
Dimension(mm)	Ø9.0	
Camera type	front view	
Max. frame rate	2560 x 720 @30fps	
Pixel size	1.4 µm x 1.4 µm	
Image sensor	1/9" x 2 Digital CMOS Camera Module	
Image area	1.819 x1.033 mm	
Scan mode	progressive	
Sensitivity	585 mV/(Lux-sec)	
Dynamic range	68.4dB @16x gain	
UVC format	MJPEG / YUV	
Storage temperature	-30 to 60 Degree C	
Working temperature	-10 to 45 Degree C	
Interface	USB 3.0	
Lens (specify which lens)	1.33mm/F4.0 (H=67°;V=41°2';D=75°1' - 75° lens) 1.32mm/F2.0; 1.32mm/F3.5 (H= 69°; V= 42° ; D= 76° - 76° lens) F4.0 (D=140° - 140° lens) 1.00mm/F4.8 (H= 118°; V= 76°; D= 128° - 128° lens)	
Operating system	windows 10, Linux, MAC OSX	

Camera Resolution 2560 x 720 high-resolution

Dual-sensor Two Independent 1/9". 1MP CMOS Sensors

Compact Size Fit for more application

More Vision with 2 lenses and more wide-angle

Video Captured

One UVC signal output



OS Support

Windows, Android, macOS



Feature

Two Independent 1/9" 1MP CMOS Sensors with two built-in lens of 75, 76, 128, 140 degree (optional). Dual lens provide wider view angle.

2560 x 720 @30fps maximum resolution per Sensor.
Dimmer LED function by customer request.

TYD-DB37209RL-76

① ② ③ ④ ⑤

① CONNECTOR		② TYPE		③ CAMERA TYPE		④ LED		⑤ LENS	
TYD	USB 3.0 A type	DB	Board type (module)	37209R	color(Module)	L	white LED	75	1.33mm/F4.0 (75°)
TYT	USB type C					L9	IR940nm LED	76	1.32mm/F2.0 (76°)
						L8	IR850nm LED	76	1.32mm/F3.5 (76°)
								140	F4.0 (140°)
								128	1.0mm/F4.8 (128°)
						with IR LED suggest to choose B/W type		1.32mm/F3.5 (76°) camera with LED light	