

Feature

- Mini Size,
- High Sensitivity,
- High Performance!



Specification

Model No.	B50408R	B50409
Dimensions (mm)	Ø 8.8	Ø 9.3 x 11.5
Orientation	Front View	
Camera Type	Board Type	
Video Format	NTSC / PAL	
Image Sensor	1/3.5" Color CMOS Camera Module	
Resolution	720 x 540	
Pixel Size (um)	5.6 x 5.6	
Image Circle	5.04	
Sensitivity (Lux.Sec)	15.3 V	
Dynamic Range	73 dB	
S/N Ratio	38 dB	
Scan Mode	Progressive	
Shutter	Rolling	
Horizontal Sync Freq.	15.734 kHz / 15.625 kHz	
Vertical Sync Freq.	60 Hz / 50 Hz	
Frame Rate (/ sec.)	60 fields / 50 fields	
Gamma Consumption	0.45	
Video Output	1Vp-p, 75 ohms Composite	
Lens	Please check model information table	
View Angle	Please check model information table	
Focus Distance (mm)	Infinity	
LED	N/A (Optional)	
Storage Temp.	-30 to 60 Degree C	
Working Temp.	-10 to 60 Degree C	
Power Supply	DC 5 V	
Power Current	TBD mA (Max.)	
Microphone	N/A (External)	

* Working temperature means the camera device, not environment temperature.

B50408R No Lens

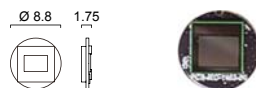

B50408 No Lens

Coming Soon



50408R



▲ MO-B50408R-3S

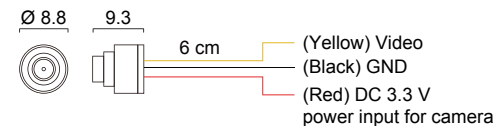

B50408R-2V (84°)



B50408R-3S (73°)



B50408R-5F (54°)



T50409L-3S (73°)



50408



▲ MX-B50408W-6F

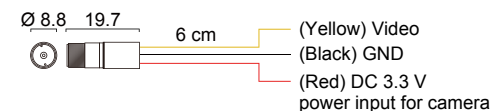

B50408W-2S (101°)

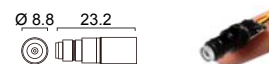

B50408W-3T (72°)



B50408W-3G2 (70°)

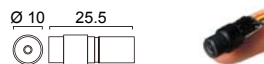

B50408W-4E (65°)



B50408W-4H (59°)



B50408W-6F (43°)



Detachable Nano Connectors (Customize Option)

Specifically designed to overcome the big size of connector and camera head.

- ✓ **With detachable Nano connectors**
A bigger size tube can go through the thin cable from halfway.

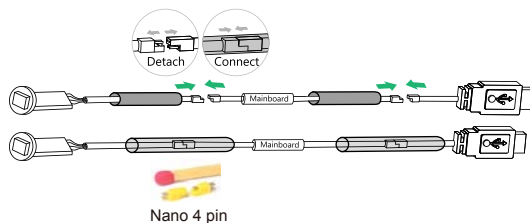

*Camera with LED and microphone will use Nano 5 Pin.

- ✗ **Without detachable Nano connectors**
Camera head cannot go through the bigger tube.

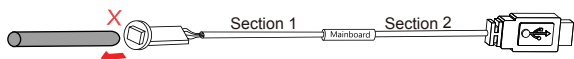

MO-B50408RALHW-2S

SERIES	CONNECTOR	CAMERA BODY	DISPLAY	MICROPHONE	LED	END SIDE
M Basic MX Low Light and Distortion Correction (Coming Soon)	CVBS Signal N/A IRIS 4 Pin (MX) O IRIS 4 Pin J Phone Jack Q M8 Waterproof F RCA / DC	Front View (V)B Board Type T Tube Type V Tube Type *V Dimmer Controller	Color 50408R 504M8R Ø 8.8 (Board Only) 50409 504M9 Ø 9.3 (Tube Only) *R Round Shape	N/A None A External	N/A None White L Normal LH High-Intensity Infrared L9 IR 940 nm L8 IR 850 nm	N/A Cable W Wires C Cable + Wires

LENS

Code	Specification	View Angle	Code	Specification	View Angle	Code	Specification	View Angle	Code	Specification	View Angle
2S	2.1 mm / F 2.5	101°	3T	3.47 mm / F 3.7	72°	4T	3.9 mm / F 3.9	66°	5F	5.0 mm / F 3.5	54°
3K	2.8 mm / F 3.9	84°	3TC	3.5 mm / F 3.5	72°	4E	4.0 mm / F 2.0	65°	6F	6.38 mm / F 4.4	43°
3W	2.8 mm / F 3.9	84°	3TF	3.5 mm / F 3.5	72°	4C	4.0 mm / F 2.0	65°	8V	8.0 mm / F 2.5	35°
2V	2.83 mm / F 3.9	84°	3G2	3.6 mm / F 2.0	70°	4V	4.3 mm / F 2.0	61°			
3S	3.4 mm / F 3.4	73°	3V	3.7 mm / F 2.5	69°	4H	4.5 mm / F 2.8	59°			

- * IR 940nm or IR 850nm LED is suggested to choose B/W camera type.
- * Camera with LED light source is suggested to use lens with larger F-Stop number.
- * Camera appearance or other requirements are applicable for customization.

Connector Information

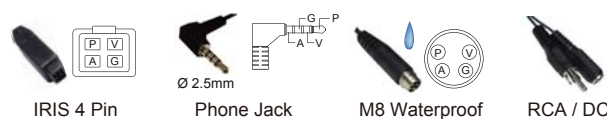

NOTE:
G GND
A AUDIO
P DC POWER
V VIDEO

