

Feature

- Miniature size.
- Outstanding quality.
- 720p image pixel.

Specification

Model No.	B20903	BL20903	BL20903S	B20903U	B20904	B20904R	B20906U	B20908R	DB20909R
Dimensions (mm)	K	∅ 3.2 x 1.4	N/A	N/A	N/A	N/A	N/A	N/A	N/A
	X	∅ 3.2 x 6.4	3.2 x 6	3.2 x 10	3.2 x 10	N/A	N/A	N/A	∅ 9 x 1.9
	T	∅ 3.5 x 13	3.2 x 12	N/A	3.2 x 12	N/A	N/A	∅ 8.6 x 2.2	N/A
	M	N/A	N/A	N/A	N/A	∅ 3.6 x 16.4	N/A	6 x 21	N/A
Orientation	Front View	Side View	Side View	Up View	Front View	Front View	Up View	Front View	Front View
Camera Type	Board Type								
Video Format	MJPEG / YUV								
Image Sensor	1/9" Color CMOS Camera Module								
Resolution	1280 x 720p @ 15~30 fps								
Pixel Size (um)	1.4 x 1.4								
Image Area (mm)	1.82 x 1.03								
Sensitivity (Lux.Sec)	585 mV								
Dynamic Range	68.4 dB @ 16x gain								
S/N Ratio	36.4 dB								
Scan Mode	Progressive								
Shutter	Rolling								
Lens	Please Check Model Information Table.								Dual Lenses
View Angle	Please Check Model Information Table.								
Focus Distance (mm)	Infinity								
LED	N/A (Optional)								
Storage Temp.	-30 to 60 Degree C								
Working Temp.	-10 to 60 Degree C								
Interface	USB 2.0								
Power Supply	DC 5 V								
Power Current (Max.)	120 mA								180 mA
Microphone	N/A								
Operation System	Win XP, Win Vista, Win 7, Win 8, Win 10 Linux, MAC OSX								

*Working temperature means the camera device, not environment temperature.

B20903 No Lens



BL20903 No Lens

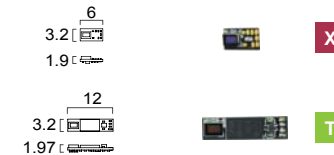

BL20903S No Lens



B20903U No Lens

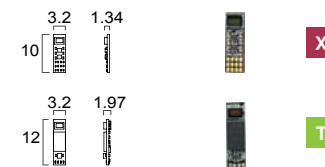

B20904 No Lens



B20904R No Lens



B20906U No Lens



B20908R No Lens

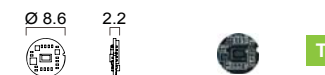

DB20909R No Lens



SERIES **K**

Lens	Front View	
	B20903 Board Type	T20904LH Tube Type (High-Intensity LED)
N/A	Ø 3.2 1.4	N/A
76	Ø 3.5 3.6	Coming Soon Ø 4 7.1
128	Ø 3.5 4.2	Coming Soon Ø 5.1 8
140	Ø 3.5 6.7	Coming Soon Ø 4 10.7

SERIES **X**

Lens	Front View				Side View		Up View
	B20903 Board Type	T20904LH Tube Type (High-Intensity LED)	B20904R Board Type	DB20909R Board Type (Dual Lens)	BL20903 Board Type	BL20903S Board Type (Signal Board)	B20903U Board Type
N/A	Ø 3.2 6.4 3.2	N/A	Ø 4.2 1.9	Ø 9 3.56	3.2 6 1.9	3.2 10 1.3	3.2 1.3 10
76	Ø 3.5 8.5	Coming Soon Ø 4 12	Ø 4.2 4.4	Ø 9 4	Ø 3.5 3.5	Ø 3.5 3.5	Ø 3.5 3.2
128	Ø 3.5 9.2	Coming Soon Ø 5.1 13	Ø 4.2 4.8	Coming Soon Ø 9 4	Ø 3.5 4.8	Ø 3.5 4.2	Ø 3.5 4.2
140	Ø 3.5 11.7	Ø 4 15.7	Ø 4.2 7.3	Coming Soon Ø 9 6	Ø 3.5 6.7	Ø 3.5 6.7	Ø 3.5 6.7

SERIES **T**

Lens	Front View			Side View	Up View
	B20903 Board Type	T20904LH Tube Type (High-Intensity LED)	B20904R Board Type	BL20903 Board Type	B20903U Board Type
N/A		N/A			
76		Coming Soon			
128		Coming Soon			
140		Coming Soon			

SERIES **M**

Lens	Front View		Up View
	B20904 Board Type	T20904LH Tube Type (High-Intensity LED)	B20906U Board Type
N/A		N/A	Coming Soon
76			Coming Soon
128			Coming Soon
140		Coming Soon	Coming Soon

CABLE Please check cable information for Section One and Section Two.

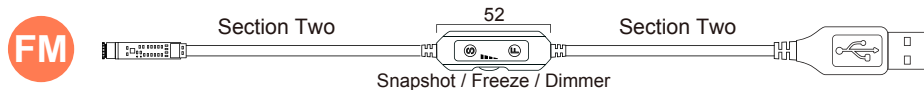
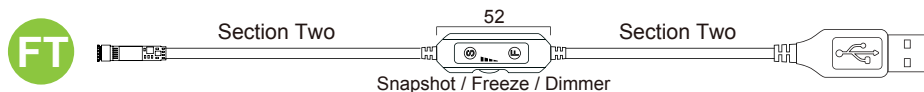
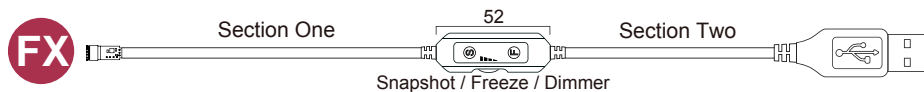
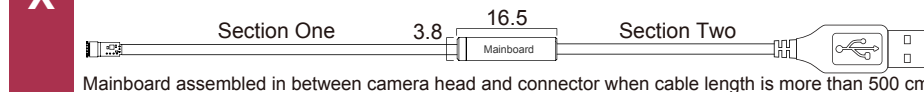
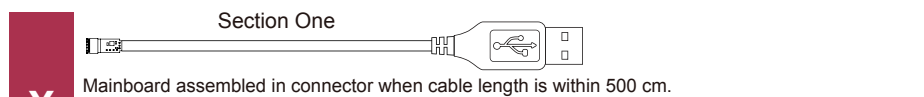
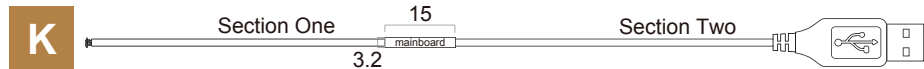

Section One (Max. 15 Pin)

OD (cm)	Length (cm)	Series
1.5 AWG#38 EN-13C	10~250	FK K FX X
1.7 AWG#36 EN-13C	10~250	
1.9 AWG#36 EN-15C	10~400 10~500	FK K FX X
2.8 AWG#32 EN-15C	10~500	FK K FX X

Section Two (Max. 7 Pin)

OD (cm)	Length (cm)	Series
0.35 Enameled Wires	10~150	
0.9 AWG#42 EN-9C	10~200	
1.4 AWG#28 EN-4C	10~1000	FK K FX X
1.4 AWG#30 EN-4C	10~600	FT T
1.6 AWG#28 EN-4C	10~1000	F M
1.7 AWG#36 EN-9C	10~200	
2.8 AWG#30 EN-7C	10~400	
3.6 AWG#28 EN-7C	10~1000	
5.0 AWG#24 EN-9C	10~1500	

Detachable Nano Connectors (Customize Option)

Specifically designed to overcome the big size of connector and camera head.

✓ **With detachable Nano connectors**
A bigger size tube can go through the thin cable from halfway.

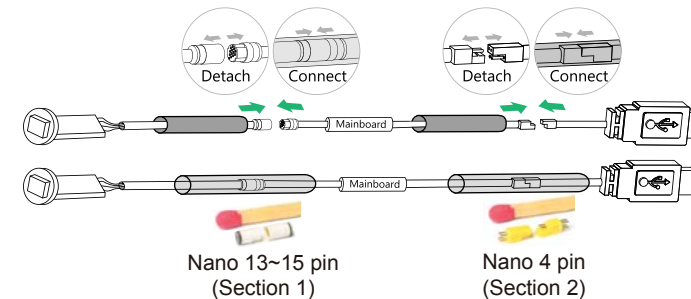

✗ **Without detachable Nano connectors**
Camera head cannot go through the bigger tube.



All MISUMI UVC Camera are Compatible With MP-WF580KP (WiFi DVR)

For example:
Our extremely lightweight 1920 x1080 (1080p) 1/6" CMOS UVC glasses camera is compatible with MP-WF580KP (WiFi DVR).

Supports **H.264 video format** input, loop recording, snapshot functions.
Supports max memory 128 GB (micro SD).

Users can view live streaming video via a smartphone.

About MP-WF580KP:
It deliver the best 1080p live streaming performance when using H.264 camera. MJPEG cameras can only live stream at resolutions of 720p and below. MJPEG cameras delivers the best live streaming performance at 640 x 480.



Camera Parameter Adjustable (MISUMI APP)

Camera parameter can be adjusted on the smartphone via the Misumi app and PC viewer software AMCAP.



NOTE: MISUMI APP does not support Android 10.

KD-B20903LH-140

SERIES	CONNECTOR	CAMERA BODY	DISPLAY								
			Front View			Side View			Up View		
USB 2.0	UVC (USB)	Front / Up View	Color	B/W	Dimensions	Color	B/W	Dimensions	Color	B/W	Dimensions
(F)K Short Head	D Type A	(V)B Board Type	20903	209M3	Ø 3.2 x 1.4 (K)	20903	209M3	3.2 x 6 (X)	20903U	209M3U	3.2 x 10 (X)
(F)X Low Temp.	M Micro-B (OTG)	(V)DB Board Type			Ø 3.2 x 6.4 (X)			3.2 x 12 (T)			3.2 x 12 (T)
(F)T Advance	T Type C	T Tube Type			Ø 3.5 x 13 (T)	20903S	209M3S	3.2 x 10	20906U	209M6U	6.0 x 21
(F)M Basic	I Mini-B	V Tube Type	20904	209M4	Ø 3.6 x 16.4	20959Z	209M59Z	Ø 5.9 x 35			
		Side View	20942Z	209M42Z	Ø 4.2 x 35						
		(V)BL Board Type	20904R	209M4R	Ø 4.2 x 1.9						
		TL Tube Type	20908R	209M8R	Ø 8.6 x 2.2						
		VL Tube Type	20909R	209M9R	Ø 9.0 x 1.9						
*F Snapshot and Freeze Frame		*V Dimmer Controller							*R Round Shape		
		*D Dual Lenses (20909R Only)							*S Signal Board		
									*U Up View		
									*Z Rigid Steel (Handle Bar)		
MICROPHONE	LED	LENS			* IR 940nm or IR 850nm LED is suggested to choose B/W camera type. * Camera with LED light source is suggested to use lens with larger F-Stop number. * Camera appearance or other requirements are applicable for customization.						
(N/A) None	(N/A) None	Code	Specification	View Angle							
	White	140	0.92 mm / F 4.5	140°							
	L Normal	128	1.00 mm / F 4.8	128°							
	LH High-Intensity	76	1.32 mm / F 2.0	76°							
	Infrared		1.32 mm / F 3.5								
	L9 IR 940 nm	39	2.88 mm / F 2.0	39°							
	L8 IR 850 nm		2.88 mm / F 4.8								

Connector Information

