

## Feature

- Miniature size.
- Outstanding quality.
- VGA image pixel.

**Global**

Shutter

**800p**

Resolution

**Real B/W**

Display

## Specification

Model No.	B441CM8R
Dimensions (mm)	Ø 7.4
Orientation	Front View
Camera Type	Board Type
Video Format	MJPEG / YUV
Image Sensor	1/4" B/W CMOS Camera Module
Resolution	1280 x 800 @ 120 fps
Pixel Size (um)	3.0 x 3.0
Image Area (mm)	3.89 x 2.45
Sensitivity (uW)	6500 mV @ 940 nm / 13000 mV @ 850 nm
Dynamic Range	68 dB
S/N Ratio	38 dB
Scan Mode	Progressive
Shutter	Global
Lens	Please Check Model Information Table
View Angle	Please Check Model Information Table
Focus Distance (mm)	Infinity
LED	N/A (Optional)
Storage Temp.	-30 to 60 Degree C
Working Temp.	-10 to 60 Degree C
Interface	USB 3.0
Power Supply	DC 5 V
Power Current	250 mA (Max.)
Microphone	N/A
Operation System	Win 10, Linux Mac OSX

\* Working temperature means the camera device, not environment temperature.

### B441CM8 No Lens



### B441CM8R



▲ YD-B441CM8R-41A

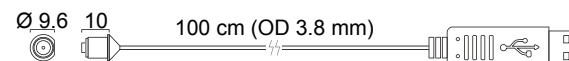

### B441CM8R-41A (41°)

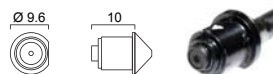

## Global Shutter



Means that all pixels of the array are exposed simultaneously.

### Advantage

- No Distortion of straight lines with fast-moving subjects
- No limit on flash sync speed

### Disadvantage

- More noise levels
- Lower frame rates
- Lower dynamic range

## Rolling Shutter



Means that adjacent rows of the array are exposed at slightly different times as the readout 'waves' sweep through each half of the sensor.

### Advantage

- Lower noise levels
- Higher frame rates
- Higher dynamic range

### Disadvantage

- Artifacts with fast-moving subjects
- Limited flash sync speeds

**Sensor No.** Please check cable information for Section One and Section Two.

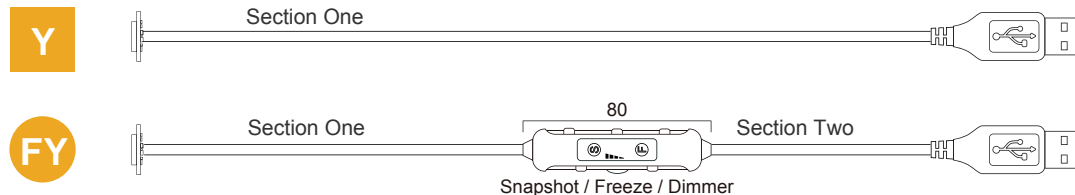

**Section One**

OD (mm)	Length (cm)	Series
2.8	10~200	FY Y
3.8		

**Section Two**

OD (mm)	Length (cm)	Series
3.6	10~250	FY Y
6.2	10~200	

**Detachable Nano Connectors (Customize Option)**

Specifically designed to overcome the big size of connector and camera head.



**With detachable Nano connectors**

A bigger size tube can go through the thin cable from halfway.

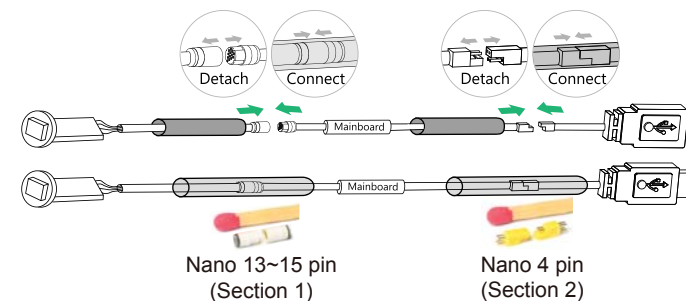

**Without detachable Nano connectors**

Camera head cannot go through the bigger tube.

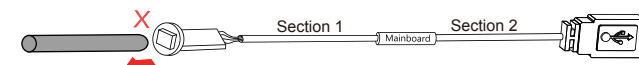

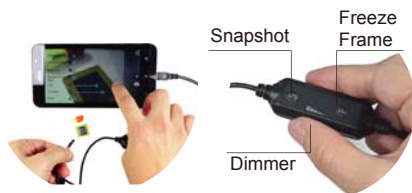

## All MISUMI UVC Camera are Compatible With MP-WF580KP (WiFi DVR)

For example:  
Our extremely lightweight 1920 x 1080 (1080p) 1/6" CMOS UVC glasses camera is compatible with MP-WF580KP (WiFi DVR).

Supports **H.264 video format** input, loop recording, snapshot functions.  
Supports max memory 128 GB (micro SD).

Users can view live streaming video via a smartphone.

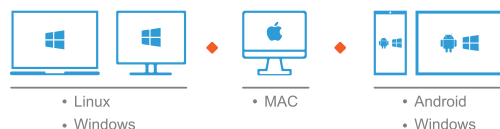

About MP-WF580KP:  
It deliver the best 1080p live streaming performance when using H.264 camera.  
MJPEG cameras can only live stream at resolutions of 720p and below.  
MJPEG cameras delivers the best live streaming performance at 640 x 480.

## Camera Parameter Adjustable (MISUMI APP)

Camera parameter can be adjusted on the smartphone via the Misumi app and PC viewer software AMCAP.

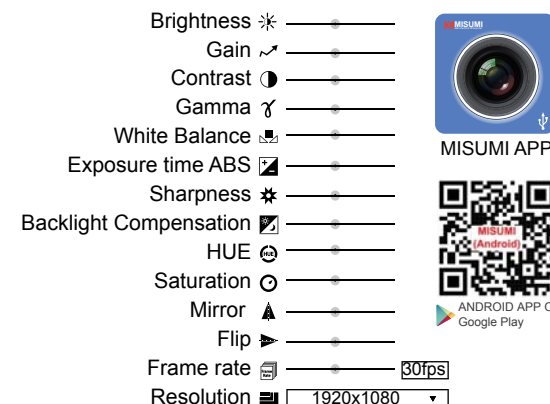

NOTE: MISUMI APP does not support Android 10.

## FYD-VB441CM8RLH-54A

SERIES	CONNECTOR	CAMERA BODY	DISPLAY	MICROPHONE	LED	LENS
<b>USB 3.0</b> (FY) Low Temperature	<b>UVC (USB)</b> D Type A M Micro-B (OTG) T Type C I Mini-B	<b>Front View</b> B Board Type VB Board Type T Tube Type V Tube Type	<b>Color</b> - 441CM8R <b>B/W</b> Dimensions Ø 7.4 x 1.7	<b>N/A</b> None	<b>N/A</b> None <b>White</b> <b>LH</b> High-Intensity <b>Infrared</b> <b>L9</b> IR 940 nm <b>L8</b> IR 850 nm	<b>Code</b> <b>Specification</b> <b>View Angle</b>
*F Snapshot and Freeze Frame		*V Dimmer Controller	*R Round Shape *C Chief Ray Angle 9°			144 2.3 mm / F 7.0 144° 120 2.65 mm / F 2.4 120° 112 2.65 mm / F 2.6 112° 73 3.51 mm / F 3.5 73° 68 3.40 mm / F 2.8 68° 54 4.5 mm / F 2.8 54° 52 4.4 mm / F 2.4 52° 41 6.0 mm / F 4.5 41°
<b>CABLE</b>				* IR 940nm or IR 850nm LED is suggested to choose B/W camera type. * Camera with LED light source is suggested to use lens with larger F-Stop number. * Camera appearance or other requirements are applicable for customization.		
<b>Camera Head to Mainboard (Section One)</b>				<b>Connector Information</b>		
<b>N/A</b> Cable OD 3.8 + 0.1 mm (Max. 200 cm) <b>A</b> Cable OD 2.8 + 0.1 mm (Max. 200 cm)				USB Type A USB Micro-B (OTG) USB Type C USB Mini-B		